

## PRODUCT

- The Premium primary regulator has been designed to control the flow of CO<sub>2</sub>, N<sub>2</sub> and mixed gases for all beverages such as beer and soft drinks.
- The base of the regulator stays the same for all products and ensures a high quality and reliable regulation of gases.
- Connections and pressure relief valves are adjusted to suit customer requirements.
- Parts used in the Premium primary regulator are made from brass or stainless steel materials and plated if required to resist corrosion and to meet installation environments.
- The Premium primary regulator can be easily extended and used as a battery for two to five regulators in a series.
- Tamper evident devices are available to fix the required setting.

## FEATURES AND BENEFITS

- High quality
- Designed to last in different environments
- Flexible design, can be modified to customer request
- High capacity
- Batteries available up to five in a series
- Easy to handle
- Automatic self-venting during reduction of pressure
- Fixed outlet pressure is an option
- Separate tamper evident device available

## SPECIFICATION

<b>MATERIAL</b>	
- body	brass Zn/Ni-plated
- valve seat	brass nickel-plated
- connections	brass Zn/Ni-plated or plastic
- brackets	stainless steel
<b>INLET CONNECTIONS</b>	
- CO <sub>2</sub>	W 21.8 x 1/14
- N <sub>2</sub> or mixed gases	W 24.32 x 1/14
- others	on request
<b>OUTLET CONNECTION</b>	
- outside thread	1/2" – 5/8" – 3/4" BSP
- inside thread	1/4"
- push-in	JG 3/8" - JG 5/16"
- others	on request
<b>INLET PRESSURE</b>	60 bar (CO <sub>2</sub> ) and 200-230 bar (N <sub>2</sub> or mixed gases)
<b>WORKING PRESSURE</b>	0.5-7 bar
<b>HIGH PRESSURE GAUGE</b>	optional
<b>LOW PRESSURE GAUGE</b>	optional
<b>PRESSURE RELIEF VALVE</b>	settings are customised - additional PRV is an option
<b>CAPACITY</b>	100 l/min maximum (continuous)
<b>WEIGHT</b>	variable from approx 1.2 kg
<b>DIMENSIONS</b>	variable from approx 120 x 120 x 90 mm
<b>MEDIA</b>	CO <sub>2</sub> , N <sub>2</sub> and mixed gases

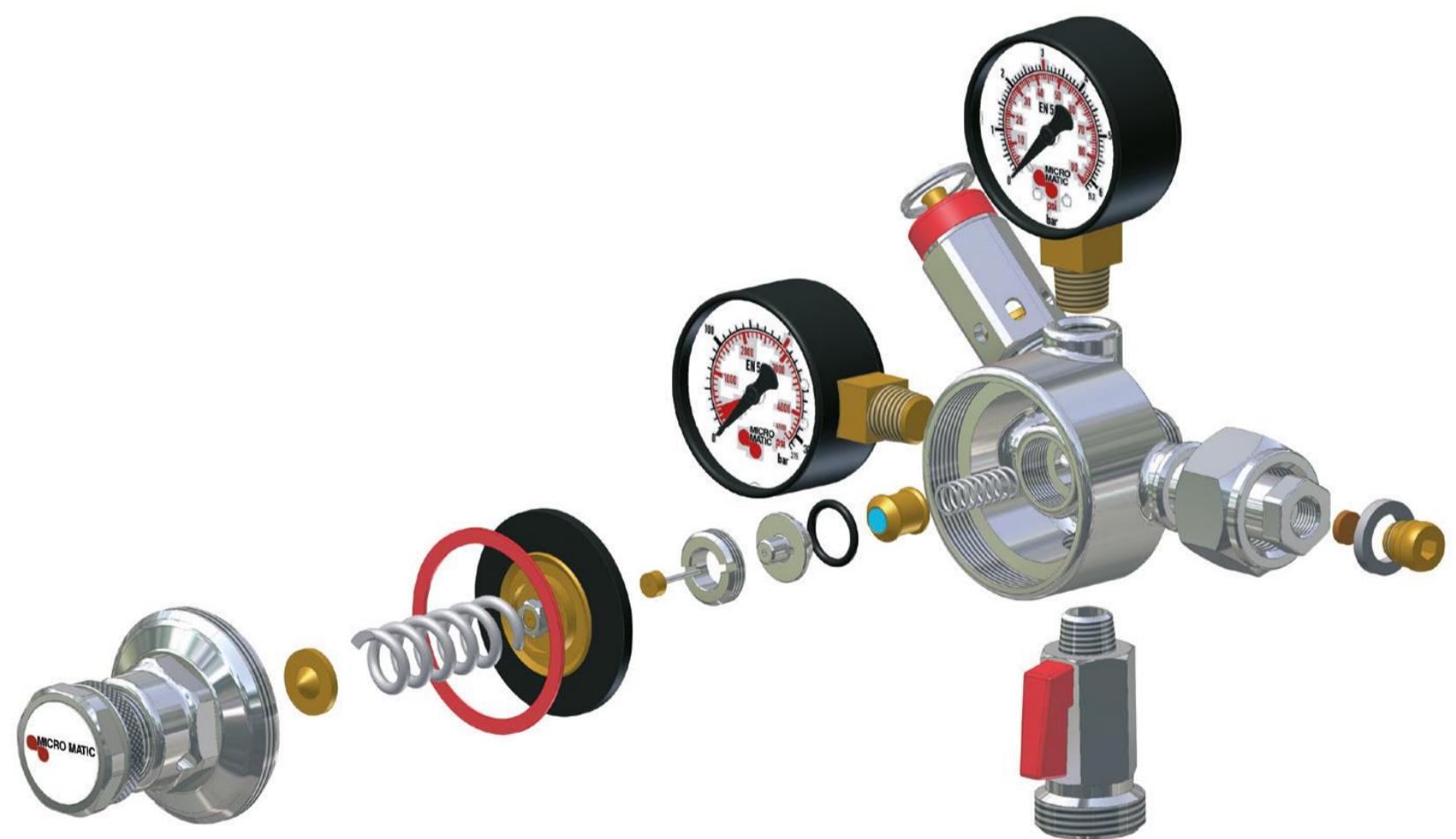

### UBC Group USA

65 North Central Dr. O'Fallon, MO 63366, USA  
 Ph.: (636) 379-2226  
 Fax: (866) 659-8904  
 Toll Free: (888) 808-9286  
 Email: [info@beer-co.us](mailto:info@beer-co.us)  
 Web: [www.beer-co.us](http://www.beer-co.us)

### UBC Group Latin America

Tokio 714, Mexico City, Mexico, 03300  
 Ph: +(52) 55 2624 3458  
 Email: [info@beer-co.com.mx](mailto:info@beer-co.com.mx)  
 Web: [www.beer-co.com.mx](http://www.beer-co.com.mx)

### UBC Group Canada

1715 Meyerside Drive, Unit 7-9,  
 Mississauga, ON, Canada, L5T1C5  
 ph.: +1 (905) 629-2597  
 Toll Free: +1 (866) 995-9965  
 fax.: +1 (905) 629-2577  
 Email: [info@beer-co.ca](mailto:info@beer-co.ca)