

Glycol Chiller Extra 1 1/2 hp

Specifications



Internal number	027.00.000.00
Part number	EG-1.5-2P EG-1.5SS-2P
Maximum distance, ft	up to 750
Capacity, BTU/h, evap 20 °F	10800
Glycol tank capacity, gal	18
Compressor power, hp	1 1/2
Dedicated circuit, amp	20
Plug type (NEMA #)	6-20P 
Voltage, V / frequency, Hz	208-230 / 60
Pump type	Vane with 1/3 hp motor
Pump, GPH	80
Number of pre-installed pumps	2
Number of additional pumps	2
Refrigerant	R404A
Width, in	29
Depth, in	23
Height, in	32 / 38 (on legs)
Weight gross/net, lb	205 / 193
Power cord length, ft	6
Inlet/Outlet barb, in	3/8
Operating ambient temperature, °F	60-90
Clearance at least	12" around the entire unit
Glycol mixture, vol%	40 % glycol and 60% water

Overall dimensions

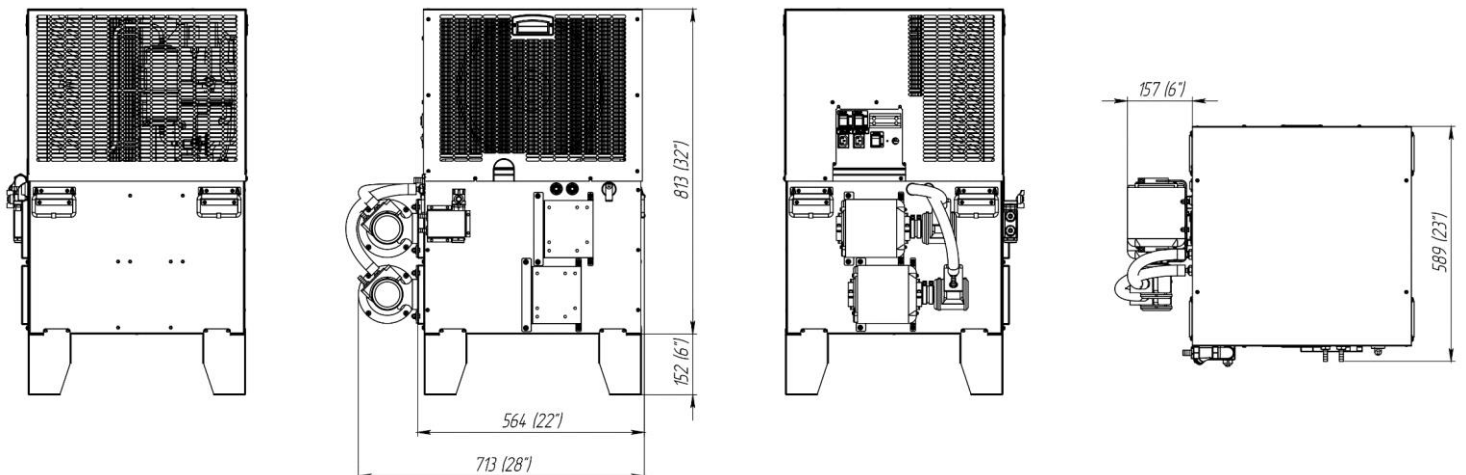

Glycol Chiller Extra 1 1/2 hp

Wiring diagram

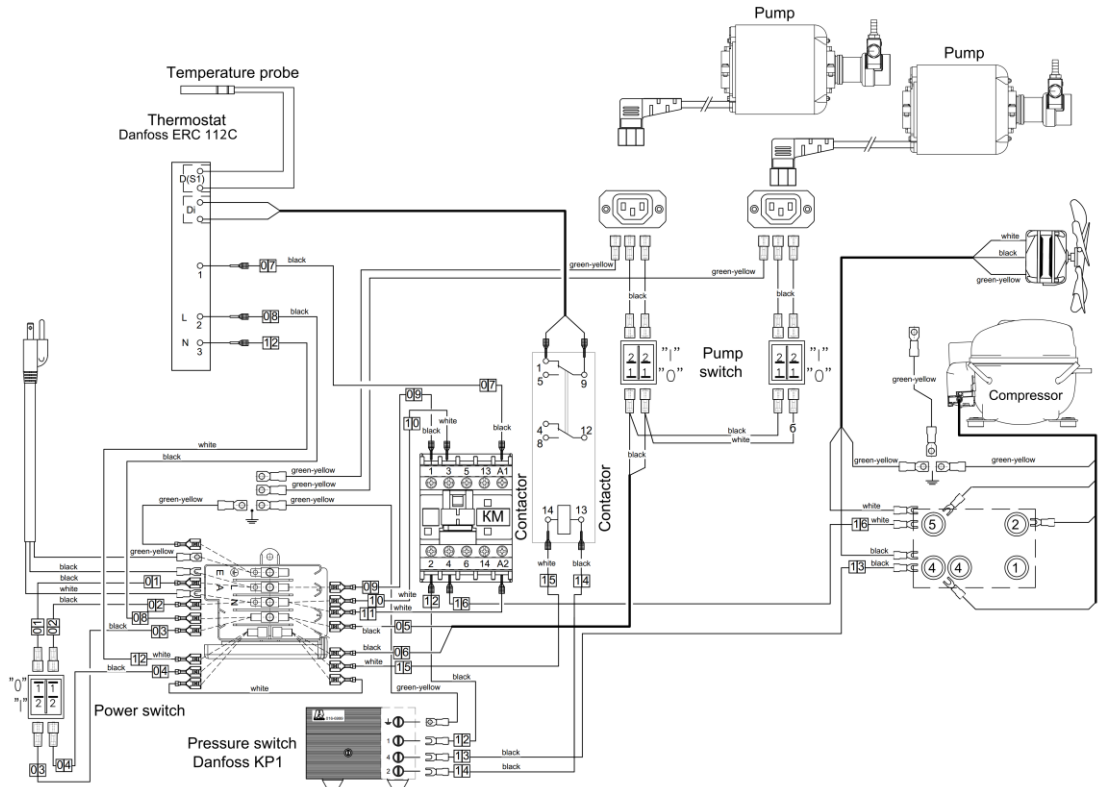

Parts

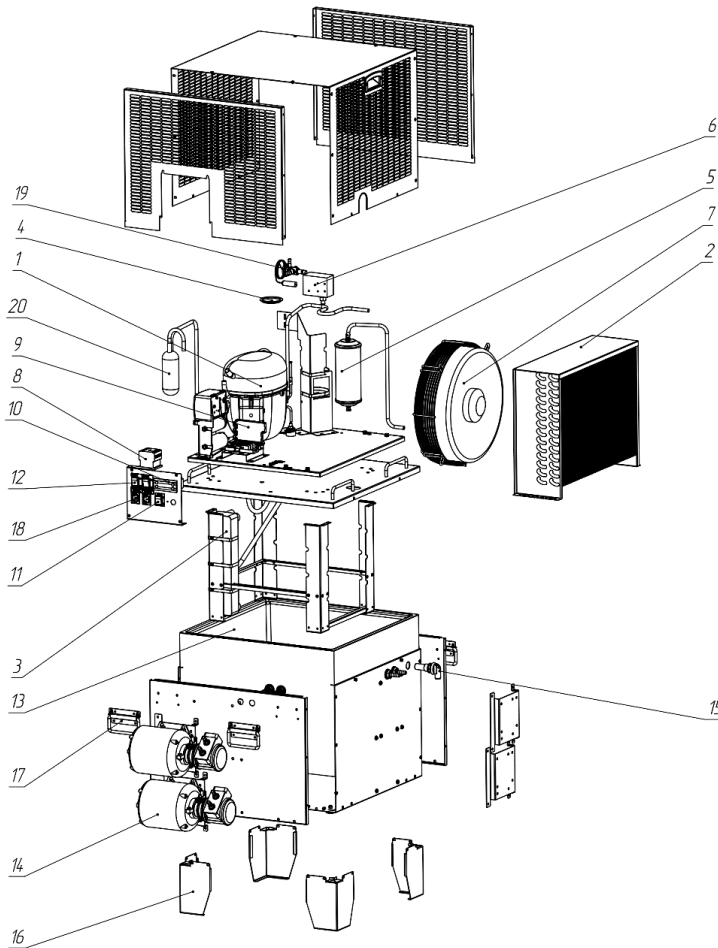

1	Compressor "EMBRACO" NTU6240GKV (230/60)
2	Air condenser KARYER TFCA2F4P5470 C
3	Evaporator "DANFOSS" D22-30
4	Cap
5	Drier-filter-receiver "DANFOSS" DMC40163s
6	Pressure switch "DANFOSS" KP2
7	Fan "WEIGUANG" YWF4E-350S
8	Contactor "DANFOSS" CI5-9-10
9	Terminal block "ITW ELETTRGIBI " PA104
10	Thermostat "DANFOSS" ERC 112C GDM
11	Power switch "ARCOLECTRIC" C6053ALBR (Red)
12	Power switch "ARCOLECTRIC " C6053ALBG (Green)
13	Glycol bath
14	Glycol pump «FLUID-O-TECH» PA 2501, cover to the pump « FLUID-O-TECH », set union joint « FLUID-O-TECH » 48 YZ and motor "MARATHON" 5KH33GNA444X (200-240 V, 50/60 Hz)
15	Overflow
16	Foot
17	Handle
18	Connector R302SN 250V/10A
19	Thermostatic expansion valve "DANFOSS" TUBE068U2109
20	Accumulator 50x165 mm.