



GLASS DOOR MERCHANDISER REFRIGERATION

UBC Part# IS-EF24-300

#C1-24GDVC

FEATURES

Features:

- Bottom mount compressor units
- Environmentally friendly R290 refrigerant
- Led lighting interior display system
- Dixell digital temperature control system
- Heavy duty Embraco compressor
- Self-closing and stay open door
- Efficient refrigeration system
- Recessed door handle
- Standard safety door lock
- Magnetic door gaskets
- Pre-installed casters
- Pre-installed shelves

Warranty:

- Two year parts and labour; Five years on compressor



CANADA

Toll Free: 1 (844) 310-0806
Web: www.beer-co.ca
Email: info@beer-co.ca

USA

Toll Free: +1-888-808-9286
Web: www.beer-co.us
Email: info@beer-co.us

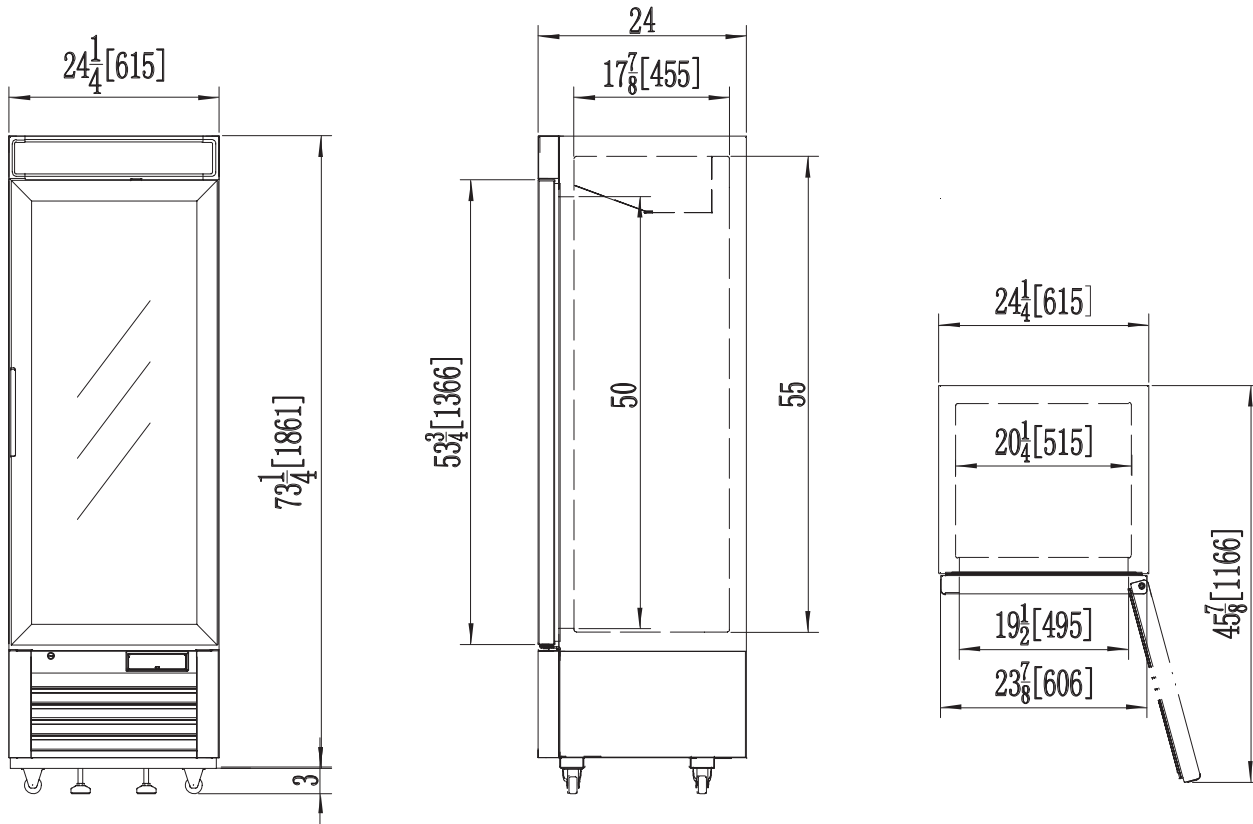

Model	Refrigerant	Doors	Shelves	Dimension (mm) (inch)			HP	Voltage	Amps	Capacity (L) (Cu Ft.)	Net Weight (KG) (LBS)	Temperature Range
				L	D	H						
C1-24GDVC	R290	1	4	615	610	1935	1/6	115/60	2.1	314	103	1 ~ 8°C
				24.2	24.0	76.2				11.1	227	33 ~ 45°F

Equipped with one NEMA 5-15P plug

SHIPPING INFORMATION

Crate Dimensions (mm) (inch)			Net Weight (KG) (LBS)	Gross Weight (KG) (LBS)
L	D	H		
668	663	2083	103	114
26.3	26.1	82	277	251

Specifications subject to change without notice.